



KONICA MINOLTA

# Rule-Based Printing

✍ An option for PageScope My Print Manager

## ✍ Category



Output Management

## ✍ Characteristics

- Unified print room management
- Print policies and rules (Rule-based printing option)
- Product-based job processing
- Print queue management



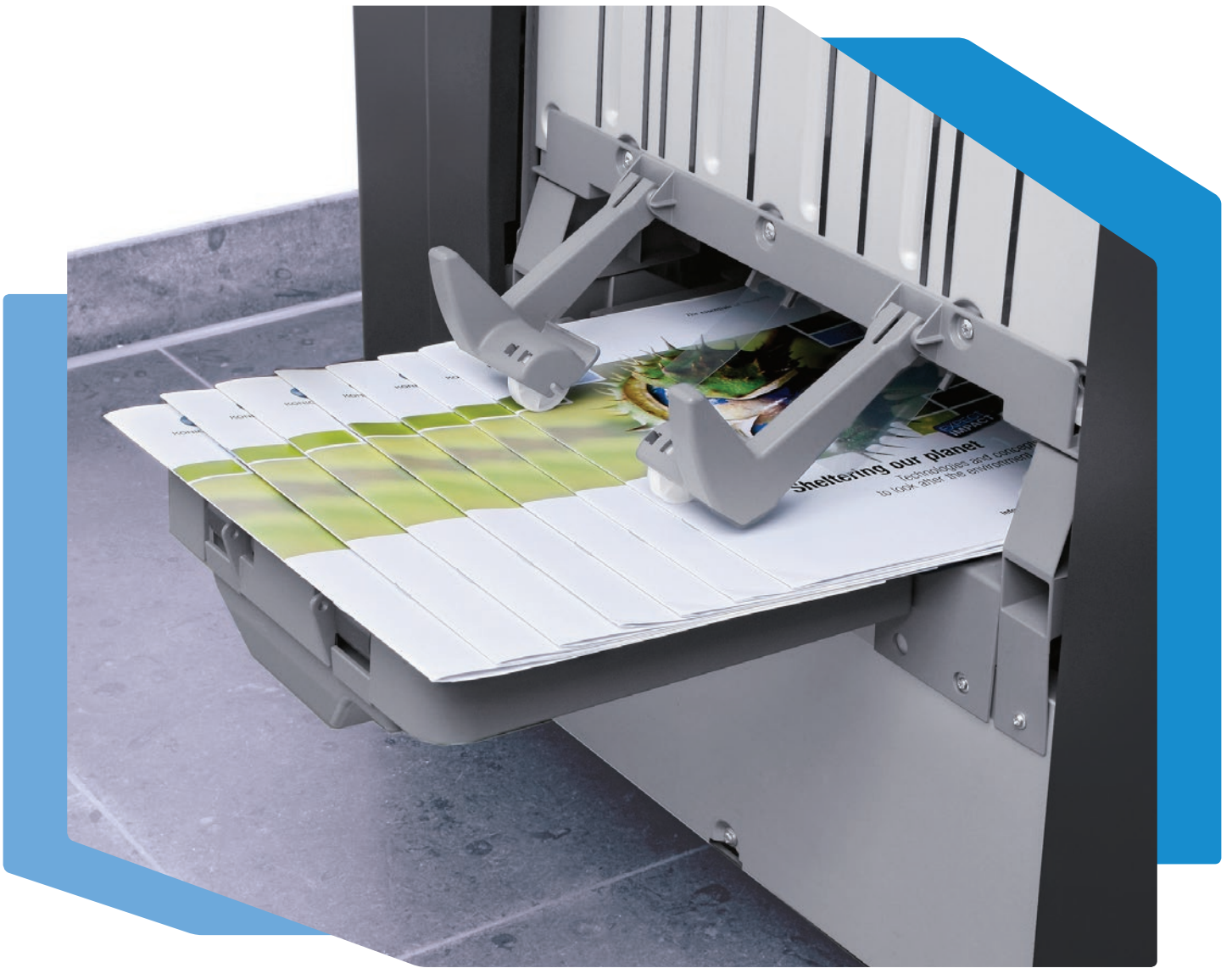

# SMART GUIDANCE FOR BUDGET- AND ECO-FRIENDLY PRINTING

**PageScope My Print Manager provides versatile functionality around personal secure printing in managed print environments. With its Rule-Based Printing Option, companies can reliably enforce printing guidelines and restrictions in order to ensure efficient print workflows for users and for company budgets.**

Document printing is an essential part of the daily business routine in corporate environments. But unless supervised and kept in close check, printing can quickly turn into a source of unexpected costs.

Independent of their size, companies need to establish clear and user recognizable guidelines for printing that offer users a certain flexibility but that nevertheless restrict printing to what is really required. This is best done by enforcing soft or strict printing rules, which might focus on certain document types, specific user groups or on avoiding the more costly print settings like colour or single-sided printing.

Through enforcing specific printing rules, every company as yet without a central printing policy will quickly tap the full potential of cost savings and achieve attractive productivity gains – whether rule-based printing is established to help save paper, to route particular print jobs to more efficient output devices, or to suppress certain print jobs altogether. The rule-based printing option of PageScope My Print Manager is the straightforward and flexible tool for all these purposes.

# KEY FEATURES

## Print policies and rules

- **Colour print control:** Companies can enforce precise colour print policies, for example limit the use of colour.
- **Application-based print control:** The administrator can configure specific restrictions governing the printing of certain document types, such as e-mails, websites, etc.
- **Printer failover:** Allows jobs to be rerouted automatically to printers that are available and ready to print, thus avoiding print queues due to "Out of toner" status or some other issue with the output device.
- **Green print policies:** Certain print modes, such as automatic duplex printing, can be set as default to stop wasteful use of paper caused by printing single-sided documents.
- **Automatic user notifications:** Users are automatically notified of any rerouting or changes to print parameters, enabling them to collect their prints directly when and where they are produced.
- **Rule timing:** Rule enforcement can be limited to specific time periods, for example outside working hours, such as weekends.
- **Custom rule creation:** The selection of job conditions and triggers as well as related actions and notifications gives the administrator enhanced control mechanisms and the flexibility to create unlimited sets of print rules.
- **Soft and strict rule enforcement:** Print policies can be defined as "strict" rules, meaning that users cannot overrule them by choice, or as "soft" rules, which users can choose to skip if required.
- **Logging of rule events:** All events that cause a rule to take effect are logged automatically, for example if a user decides to ignore suggestions for soft print rules.

## Print queue management

- **Hold selected jobs in secure print queue:** In combination with the follow-me functionality of PageScope My Print Manager, specific rules can be defined to hold print jobs in the central print queue for secured authenticated printing, disabling direct printouts.



# WORKFLOW

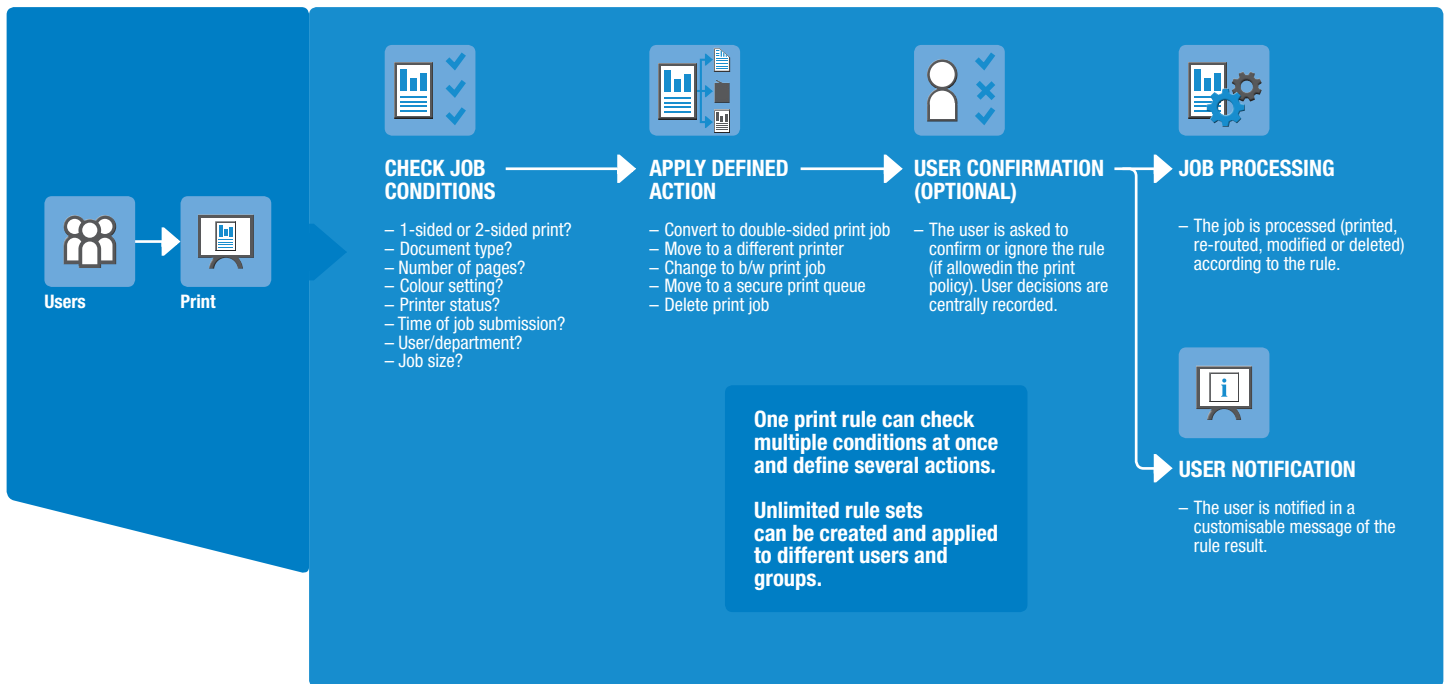

# TECHNICAL SPECIFICATIONS

## SYSTEM REQUIREMENTS

<b>Operating systems</b>	Windows Server 2003, Standard Edition (SP2 or later) Windows Server 2003, Standard x64 Edition (SP2 or later) Windows Server 2003, Enterprise Edition (SP2 or later) Windows Server 2003, Enterprise x64 Edition (SP2 or later) Windows Server 2003 R2, Standard Edition (SP2 or later) Windows Server 2003 R2, Standard x64 Edition (SP2 or later) Windows Server 2003 R2, Enterprise Edition (SP2 or later) Windows Server 2003 R2, Enterprise x64 Edition (SP2 or later) Windows Server 2008 Standard (SP2 or later) * Windows Server 2008 Enterprise (SP2 or later) * Windows Server 2008 Standard without Hyper-V (SP2 or later) * Windows Server 2008 Enterprise without Hyper-V (SP2 or later) * Windows Server 2012 Standard Windows Server 2012 R2 Standard Windows Vista Business (SP2 or later) * Windows Vista Enterprise (SP2 or later) * Windows Vista Ultimate (SP2 or later) * Windows 7 Professional (SP1 or later) * Windows 7 Enterprise (SP1 or later) * Windows 7 Ultimate (SP1 or later) * Windows Server 2008 R2 Standard (SP1 or later) Windows Server 2008 R2 Enterprise (SP1 or later) Windows 8 Pro * Windows 8 Enterprise * Windows 8.1 Pro * Windows 8.1 Enterprise *
--------------------------	---

<b>Memory</b>	3 GB or higher
<b>Hard disk space</b>	500 MB or higher (required for initial installation)
<b>CPU</b>	Intel Core 2 Duo E8600 3.33 GHz or higher
<b>.NET Framework</b>	Microsoft .NET Framework 2.0 SP2 Microsoft .NET Framework 3.5 SP1 Microsoft .NET Framework 4.0 or later
<b>Internet information services</b>	Microsoft Internet Information Services 5.0 or later
<b>Database server</b>	Microsoft SQL Server 2005 Express/Standard/Enterprise Microsoft SQL Server 2008 Express/Standard/Enterprise Microsoft SQL Server 2008 R2 Express/Standard/Enterprise Microsoft SQL Server 2012 Express/Standard/Enterprise
<b>Supported languages user/admin interface</b>	English, French, Italian, German, Spanish, Dutch, Danish Czech, Polish, Swedish, Norwegian, Finnish
<b>Supported MFPS</b>	Simple job routing is supported with any networked output device; the compatibility depends on the used printer drivers. Conversion of print jobs (e.g. from single-sided to double-sided) requires Konica Minolta driver technology. Embedded pull printing is supported on Konica Minolta bizhub devices with OpenAPI 3.x. Pull printing via external terminal is supported on MFPS/printers without OpenAPI and on third-party devices.
<b>Software</b>	To activate the Rule-Based Printing Option by licence, the My Print Manager module of the PageScope Enterprise Suite has to be licensed first.

The support and availability of the listed specifications and functionalities varies depending on operating systems, applications and network protocols as well as network and system configurations.

\* The 32-bit (x86) and 64-bit (x64) editions of Windows are supported.